

LEGEND	
	EXISTING KERB LINE
	APPROVED ROAD MARKINGS/TRAFFIC CONTROLS
	EXISTING ROAD MARKINGS FOR APPROVAL
	NEW KERB LINE/ROAD MARKINGS
	REMOVED ROAD MARKINGS
	REMOVED KERB LINE/EDGE OF SEAL
	EXISTING SIGN
	EXISTING VEHICLE ENTRANCE

NOTES	
•	ALL TRAFFIC AND PARKING SIGNS ARE TO BE INSTALLED AS PER TDM, ATCOP AND/OR RELEVANT LEGISLATION REQUIREMENT.
•	ALL MEASUREMENTS ARE ROUNDED TO THE NEAREST 0.5m.
•	SIGNS AND MARKINGS ARE INDICATIVE ONLY AND MAY NOT REFLECT FINAL POSITIONS.
•	ALL VEHICLE ENTRANCES ARE INDICATIVE ONLY AND MAY NOT REFLECT FINAL POSITIONING.
•	THESE RESOLUTION DRAWINGS ARE NOT TO BE USED FOR CONSTRUCTION.

DESIGNED BY: PREPARED BY: For:

PROJECT NAME: MAURANUI AVENUE, REMUERA, ALBERT-EDEN LOCAL BOARD.  
RESOLUTION PLAN - NEW BUS LAYOVER.

RESOLUTION ID  
**18459**

Design: eliga	Scale: N.T.S
Survey: eliga	DWG#: PTM/AELB/18459/ND/391-216
Drawn: ND/PTM	Rev: A
Date: 18 December 2023	Sheet#: SHEET 1 OF 4

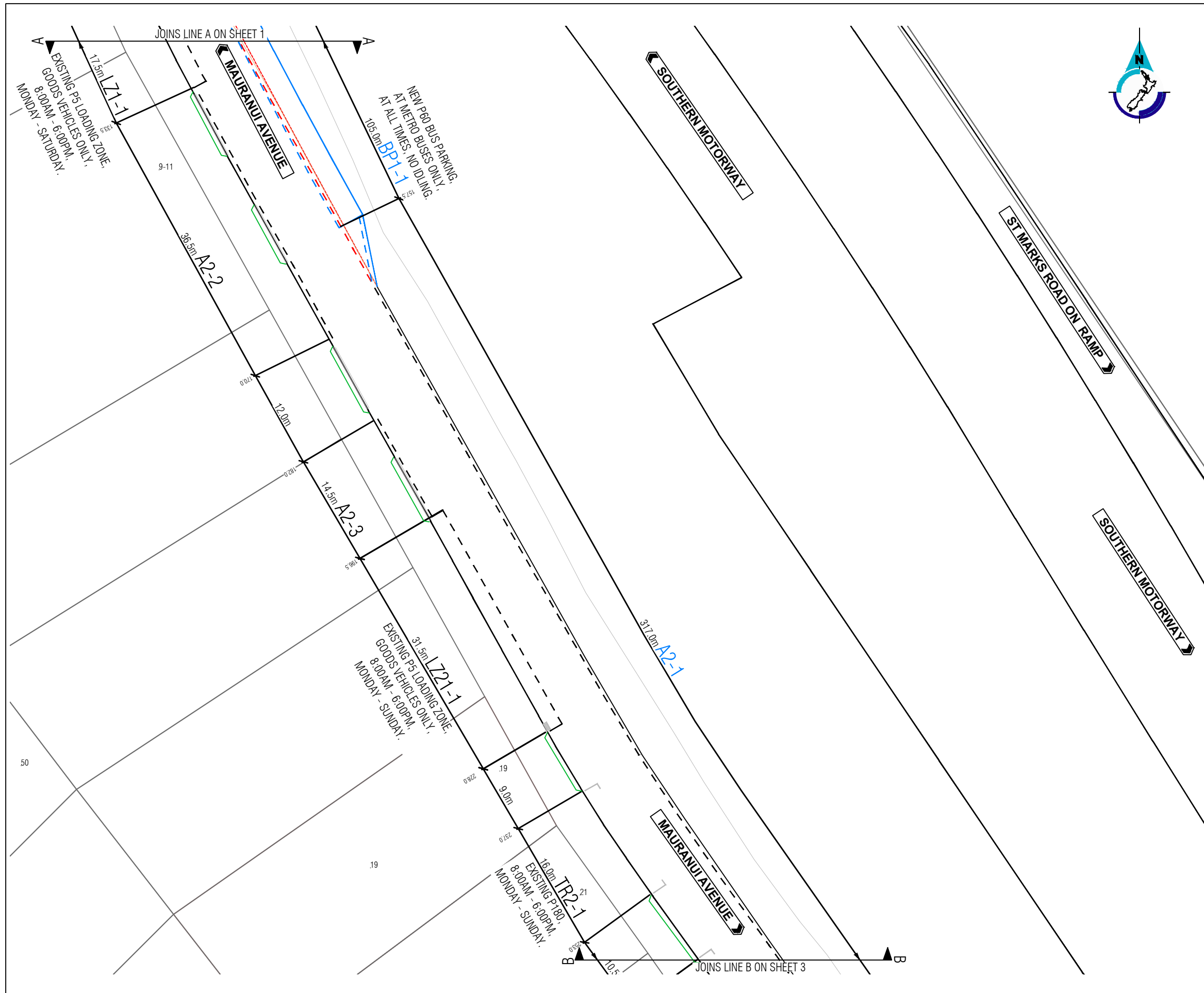

**LEGEND**

	EXISTING KERB LINE
	APPROVED ROAD MARKINGS/TRAFFIC CONTROLS
	EXISTING ROAD MARKINGS FOR APPROVAL
	NEW KERB LINE/ROAD MARKINGS
	REMOVED ROAD MARKINGS
	REMOVED KERB LINE/EDGE OF SEAL
	EXISTING SIGN
	EXISTING VEHICLE ENTRANCE

- NOTES**
- ALL TRAFFIC AND PARKING SIGNS ARE TO BE INSTALLED AS PER TDM, ATCOP AND/OR RELEVANT LEGISLATION REQUIREMENT.
  - ALL MEASUREMENTS ARE ROUNDED TO THE NEAREST 0.5m.
  - SIGNS AND MARKINGS ARE INDICATIVE ONLY AND MAY NOT REFLECT FINAL POSITIONS.
  - ALL VEHICLE ENTRANCES ARE INDICATIVE ONLY AND MAY NOT REFLECT FINAL POSITIONING.
  - THESE RESOLUTION DRAWINGS ARE NOT TO BE USED FOR CONSTRUCTION.

DESIGNED BY:

PREPARED BY:

For:

PROJECT NAME: MAURANUI AVENUE, REMUERA, ALBERT-EDEN LOCAL BOARD.  
 RESOLUTION PLAN - NEW BUS LAYOVER.

RESOLUTION ID  
**18459**

Design: eliga	Scale: N.T.S
Survey: eliga	DWG#: PTM/AELB/18459/ND/391-216
Drawn: ND/PTM	Rev: A
Date: 18 December 2023	Sheet#: SHEET 2 OF 4

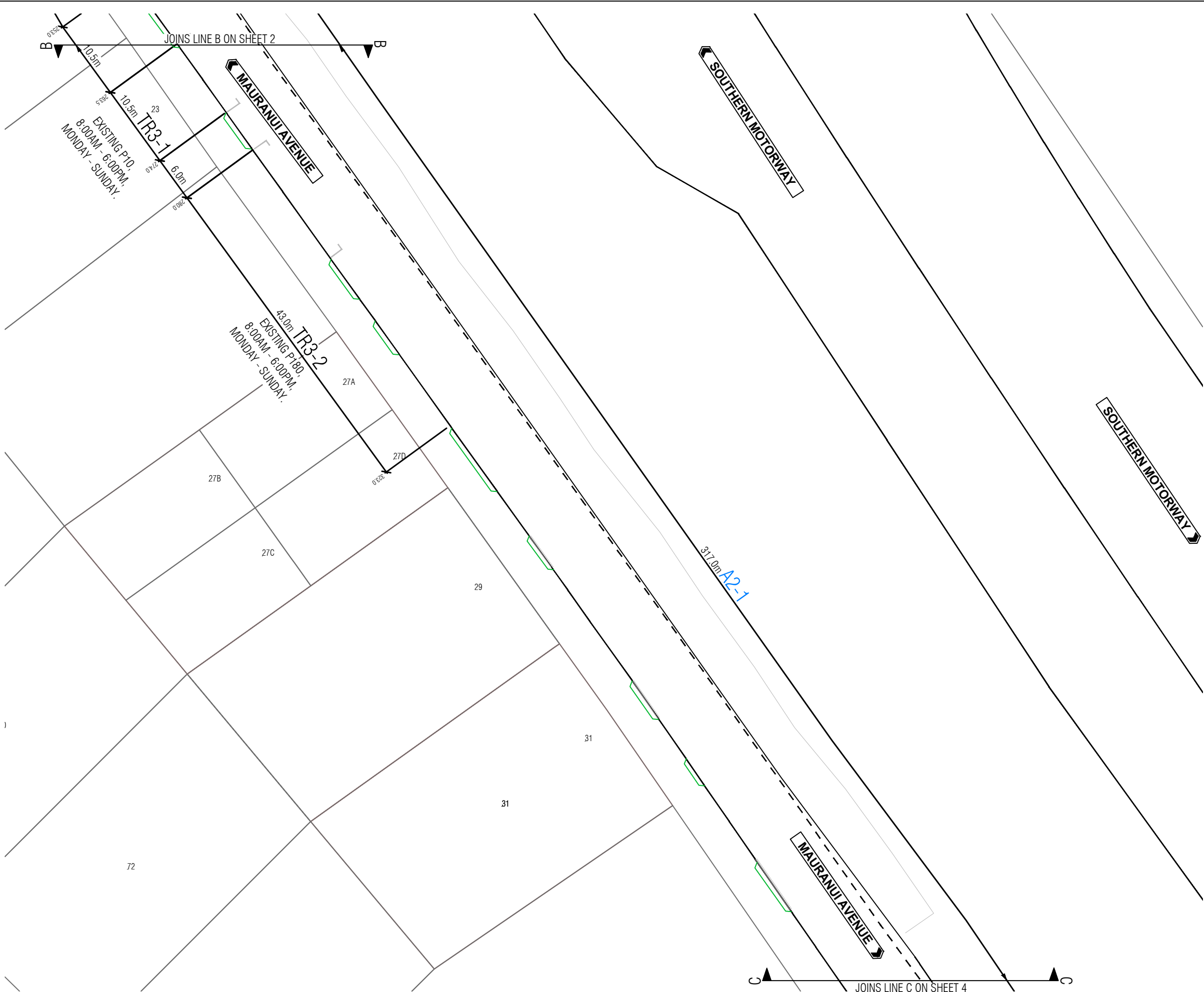

**LEGEND**

- EXISTING KERB LINE
- APPROVED ROAD MARKINGS/TRAFFIC CONTROLS
- EXISTING ROAD MARKINGS FOR APPROVAL
- NEW KERB LINE/ROAD MARKINGS
- REMOVED ROAD MARKINGS
- REMOVED KERB LINE/EDGE OF SEAL
- EXISTING SIGN
- EXISTING VEHICLE ENTRANCE

**NOTES**

- ALL TRAFFIC AND PARKING SIGNS ARE TO BE INSTALLED AS PER TDM, ATCOP AND/OR RELEVANT LEGISLATION REQUIREMENT.
- ALL MEASUREMENTS ARE ROUNDED TO THE NEAREST 0.5m.
- SIGNS AND MARKINGS ARE INDICATIVE ONLY AND MAY NOT REFLECT FINAL POSITIONS.
- ALL VEHICLE ENTRANCES ARE INDICATIVE ONLY AND MAY NOT REFLECT FINAL POSITIONING.
- THESE RESOLUTION DRAWINGS ARE NOT TO BE USED FOR CONSTRUCTION.

DESIGNED BY:

PREPARED BY:

For:

PROJECT NAME: MAURANUI AVENUE, REMUERA, ALBERT-EDEN LOCAL BOARD.  
RESOLUTION PLAN - NEW BUS LAYOVER.

RESOLUTION ID  
**18459**

Design: eliga	Scale: N.T.S
Survey: eliga	DWG#: PTM/AELB/18459/ND/391-216
Drawn: ND/PTM	Rev: A
Date: 18 December 2023	Sheet#: SHEET 3 OF 4

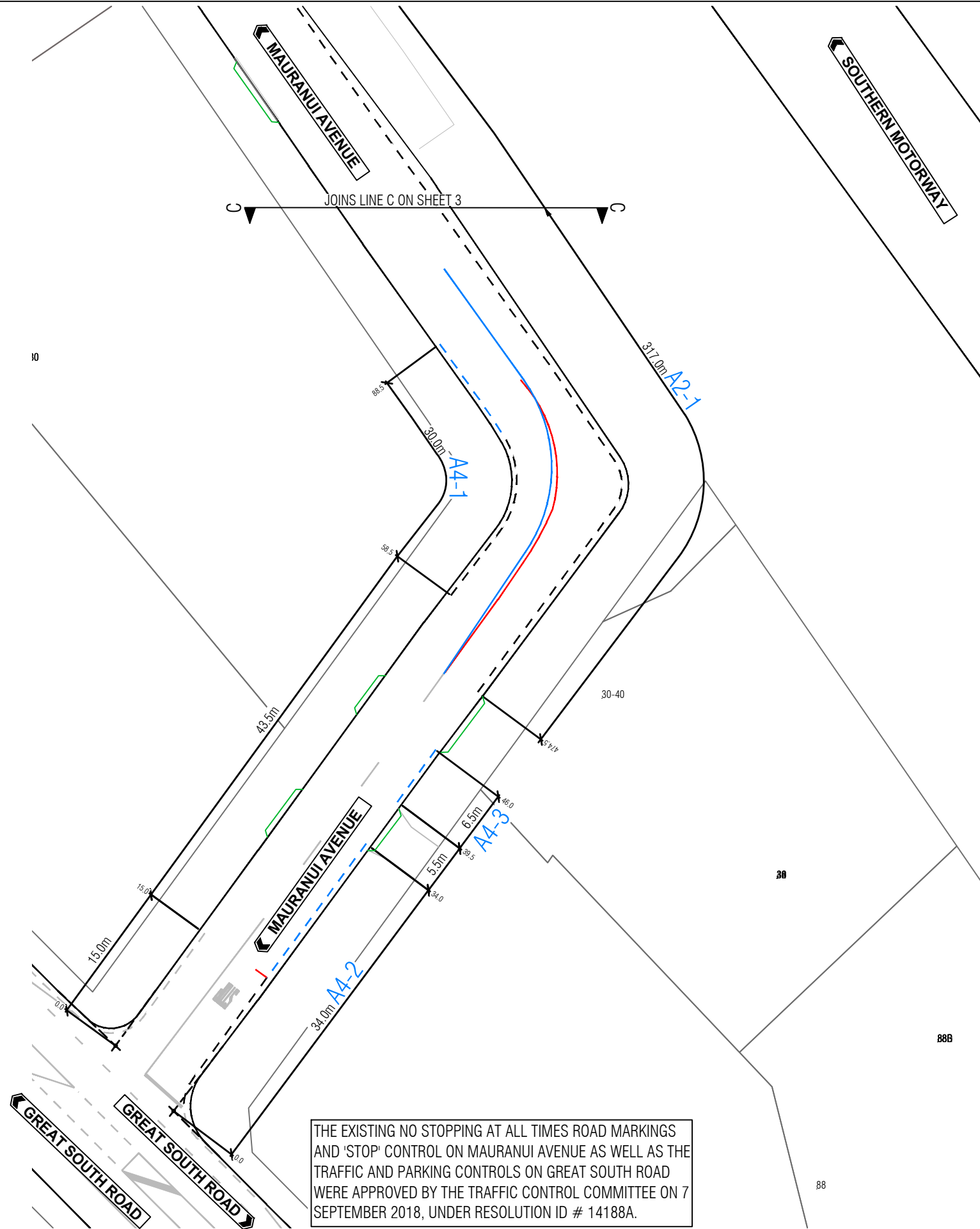

THE EXISTING NO STOPPING AT ALL TIMES ROAD MARKINGS AND 'STOP' CONTROL ON MAURANUI AVENUE AS WELL AS THE TRAFFIC AND PARKING CONTROLS ON GREAT SOUTH ROAD WERE APPROVED BY THE TRAFFIC CONTROL COMMITTEE ON 7 SEPTEMBER 2018, UNDER RESOLUTION ID # 14188A.

LEGEND	
	EXISTING KERB LINE
	APPROVED ROAD MARKINGS/TRAFFIC CONTROLS
	EXISTING ROAD MARKINGS FOR APPROVAL
	NEW KERB LINE/ROAD MARKINGS
	REMOVED ROAD MARKINGS
	REMOVED KERB LINE/EDGE OF SEAL
	EXISTING SIGN
	EXISTING VEHICLE ENTRANCE

- NOTES**
- ALL TRAFFIC AND PARKING SIGNS ARE TO BE INSTALLED AS PER TDM, ATCOP AND/OR RELEVANT LEGISLATION REQUIREMENT.
  - ALL MEASUREMENTS ARE ROUNDED TO THE NEAREST 0.5m.
  - SIGNS AND MARKINGS ARE INDICATIVE ONLY AND MAY NOT REFLECT FINAL POSITIONS.
  - ALL VEHICLE ENTRANCES ARE INDICATIVE ONLY AND MAY NOT REFLECT FINAL POSITIONING.
  - THESE RESOLUTION DRAWINGS ARE NOT TO BE USED FOR CONSTRUCTION.

DESIGNED BY: PREPARED BY: For:

PROJECT NAME: MAURANUI AVENUE, REMUERA, ALBERT-EDEN LOCAL BOARD.  
RESOLUTION PLAN - NEW BUS LAYOVER.

RESOLUTION ID  
**18459**

Design: eliga	Scale: N.T.S
Survey: eliga	DWG#: PTM/AELB/18459/ND/391-216
Drawn: ND/PTM	Rev: A
Date: 18 December 2023	Sheet#: SHEET 4 OF 4