

# Standard Detail Drawings

### *General*

- G1 Private Right of Way
- G2 Non-residential/Business Private Ways Construction

### *Roading*

- R1 Road Name Sign
- R2 Services Layout Berm Cross Section (urban)
- R3 Design Chart Flexible Pavements
- R4 Vehicle Crossing (urban) Footpath Adjacent to Kerb
- R5 Vehicle Crossing (urban) Footpath Away from Kerb
- R6 Vehicle Crossing (urban) High Speed Turnoff
- R7 Vehicle Crossing Commercial
- R8 Vehicle Crossing (urban) Drainage via Grass Berm
- R9 Vehicle Crossing (urban) Non-standard Berm Slope
- R11 Intersection Sight Distance
- R13 Cul-de-sac Head Dimensions
- R14 Cul-de-sac Head Alternatives
- R16 Typical Dimensions Kerb and Channel
- R17 Typical Catchpit Details
- R19 Recess Catchpit
- R21 Wheelchair Ramp Kerb Crossing
- R29 Standard Rural Property Entrance – Residential
- R31 Private Heavy Vehicle Access
- R32 Sand for Use in Replacement of Undercuts in Road Works

### *Stormwater*

- SW1 Stormwater Catchment Boundaries
- SW2 Design Rainfall DDF Curves
- SW3 Onehunga-Manukau Harbour Datums & Tides
- SW4 Cast in Situ Reinforced Concrete Drainage Structures
- SW5 Precast Manhole Flanged Base up to 4.5m Deep
- SW6 Stormwater Manhole Details Cast In-Situ Base
- SW7 Precast Manhole Cast In-Situ Base for Pipes >600mm
- SW8 Manhole Throat Details
- SW9 PE Pipe Manhole Connections
- SW10 Stormwater Catchment Boundaries
- SW11 Catchpit 1 of 2
- SW11 Catchpit 2 of 2
- SW13 RAMP Riser for Stormwater House Connections
- SW14 Anchor Block Details
- SW15 Pipe Bedding
- SW16 Inlet and Outlet Structures
- SW17 Build Over Influence Zone and Clearances to Manholes
- SW18 Foundation/Pipe Clearances for Building Close to Public Drains
- SW19 Minimum Freeboard Requirements for Building Adjacent to Floodplains
- SW20 Groundwater Recharge Pit for Peat Areas Plan
- SW21 Groundwater Recharge Pit for Peat Areas Cross Section
- SW22 Recharge Pit Feature Dimensions V Impervious Area

*Waste Water*

Contact United Water (U.W.I.)

*Water*

Contact United Water (U.W.I.)

*Parks and Reserves*

- P1 Pedestrian Accessway Details
- P3 Standard Park Barriers
- P4 Berm Cross-Section for Tree Landscaping
- P5 Street Tree Placement

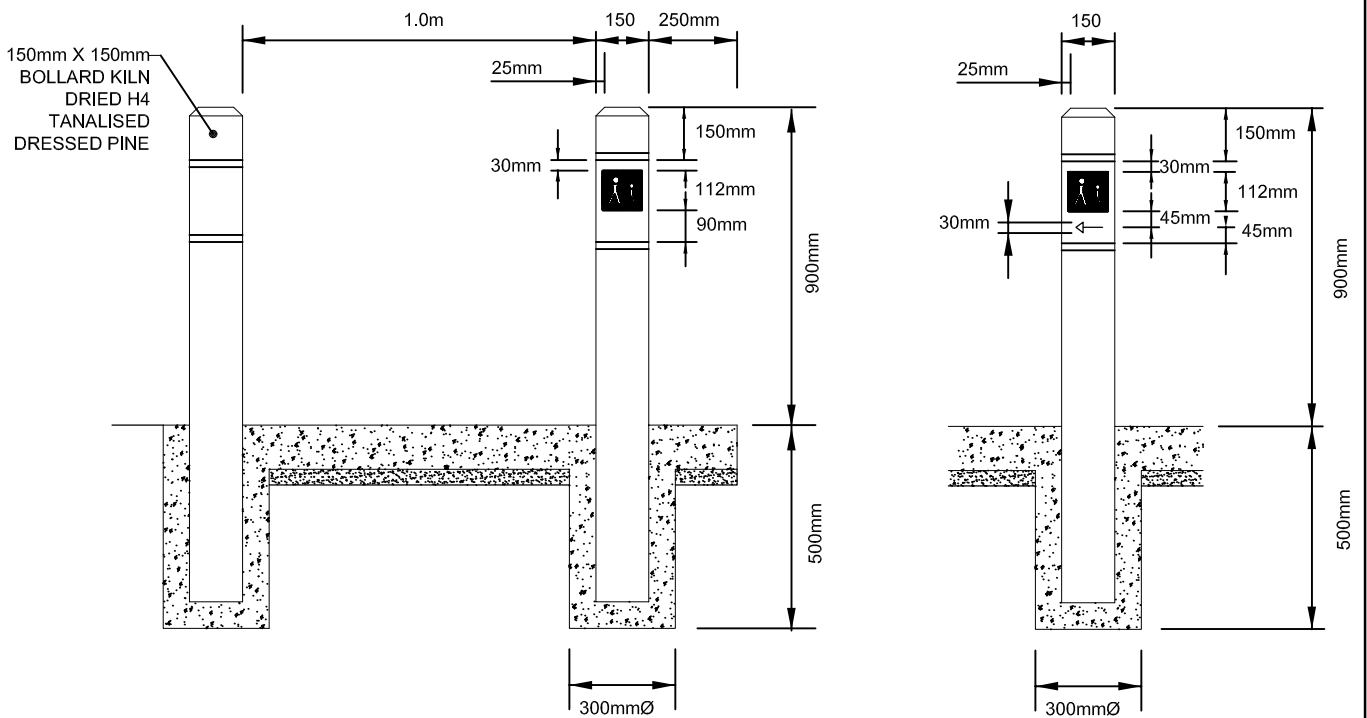
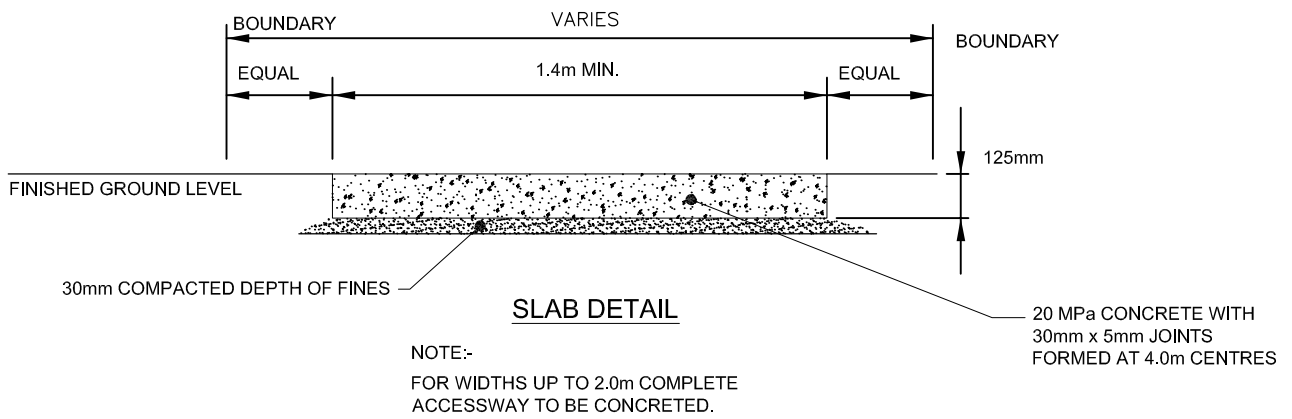

**ENTRY BOLLARDS**

LOCATED AT ROAD BOUNDARY

**SIDE ELEVATION**

**BOLLARD CONSTRUCTION NOTE:-**

1. OUTDOOR RECREATION SYMBOL NO. 50 TO NZS 8603:1992 STANDARD, ON FRONT AND SIDES OF POSTS ONLY.
2. SYMBOLS AND DIRECTIONAL ARROWS TO BE CHECKED 10mm INTO POSTS.
3. 10mm ROUTED GROOVES TO BE CUT ON ALL FOUR FACES OF THE POSTS WITH THE GROOVES LINING UP.
4. GROOVES HIGHLIGHTED IN BLUE.
5. POST WITH SYMBOLS TO BE INSTALLED ON THE RIGHTHAND SIDE LOOKING INTO THE WALKWAY.
6. DIRECTIONAL ARROWS TO BE ON THE SIDE ONLY, AND POINTING INTO THE WALKWAY.



DATE ISSUED: JUNE 2009

DWG NO: P 1

**PEDESTRIAN ACCESSWAY**

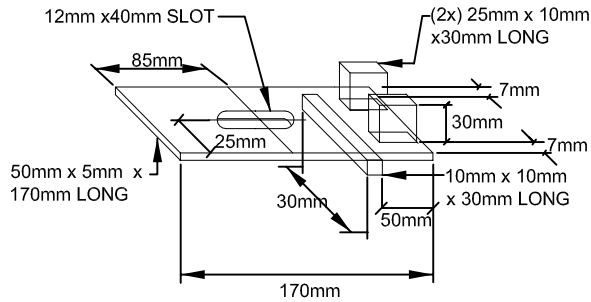
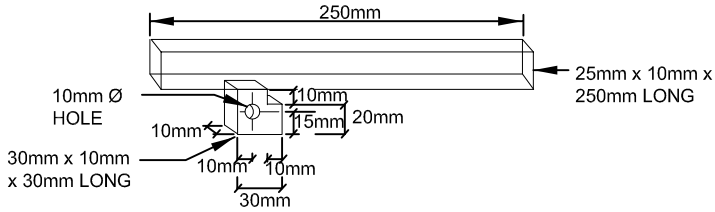

**LATCH DETAIL**

**NOTE:**

ALL COMPONENTS HOT DIPPED GALVANISED AND ALL FILLET WELDS ARE AT 5mm.

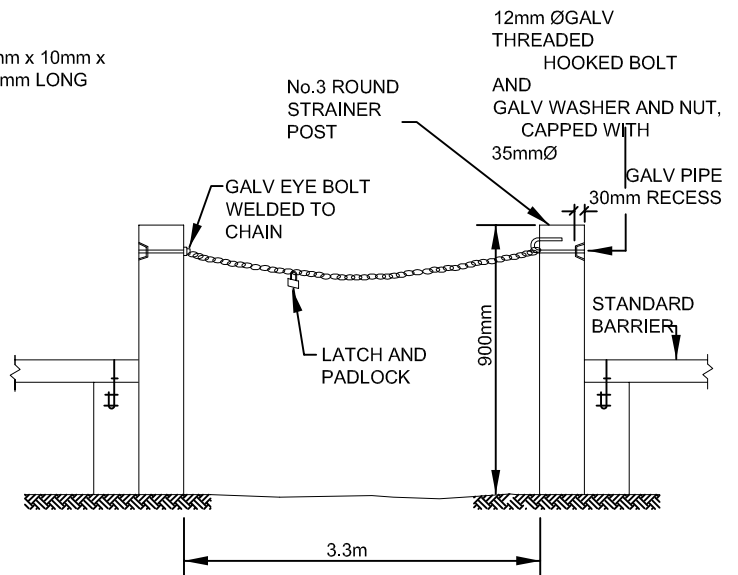

**GATE DETAIL**

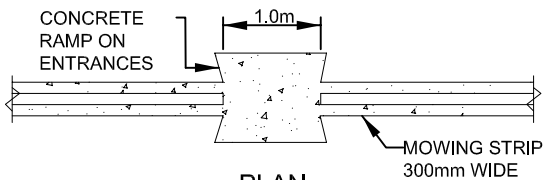

**PLAN**

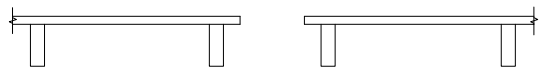

**PEDESTRIAN  
ACCESS  
ELEVATION**

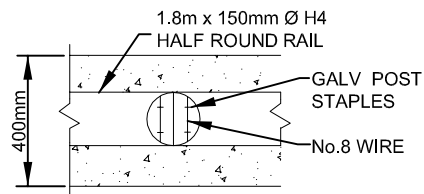

**PLAN**

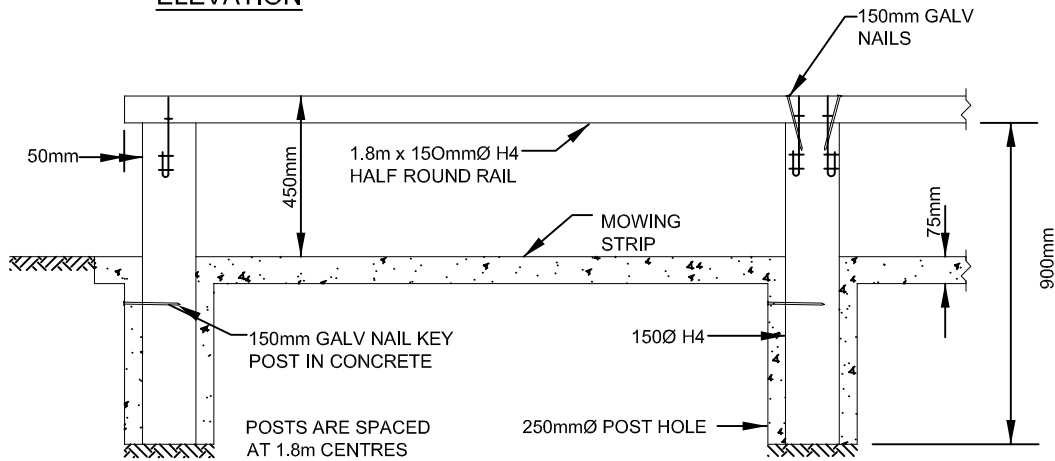

**BARRIER END AND STANDARD POST DETAIL ELEVATION**



**PAPAKURA  
DISTRICT COUNCIL**

DATE ISSUED: **JUNE 2009**

DWG NO: **P 3**

**STANDARD PARK BARRIERS**

**NOTE:**

SPECIFIC APPROVAL IS REQUIRED FOR STRUCTURES IN ROAD RESERVE CONSIDERING FOLLOWING CRITERIA

1. ROAD HIERARCHY
2. PROXIMITY OF THE ROAD INTERSECTION
3. PROXIMITY OF VEHICULAR AND PEDESTRIAN CROSSINGS
4. TRAFFIC VOLUME DUCTS WILL BE REQUIRED TO ALLOW FOR SERVICES

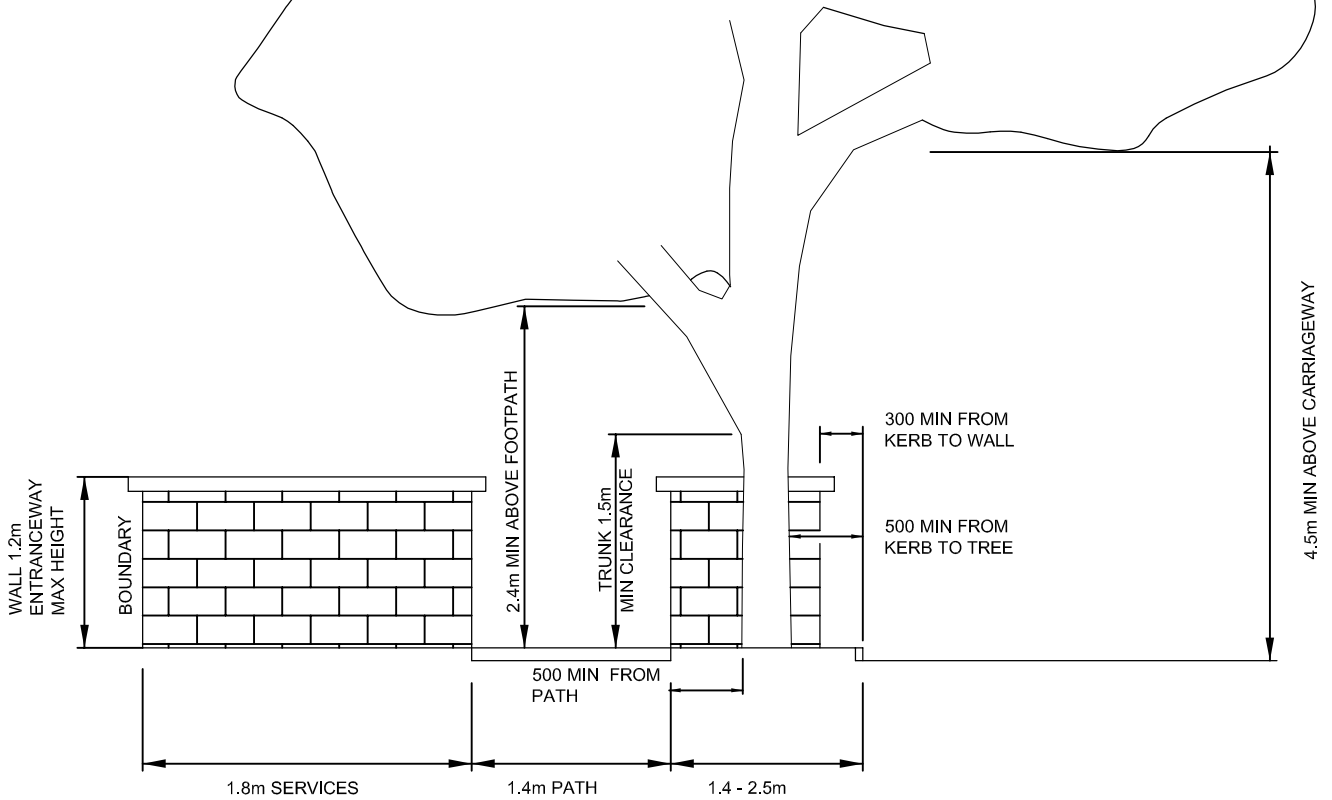

**PAPAKURA**  
DISTRICT COUNCIL

DATE ISSUED: JUNE 2009

DWG NO: P 4

## STANDARD BERM CROSS - SECTION WITH ENVELOPES FOR TREE LANDSCAPING

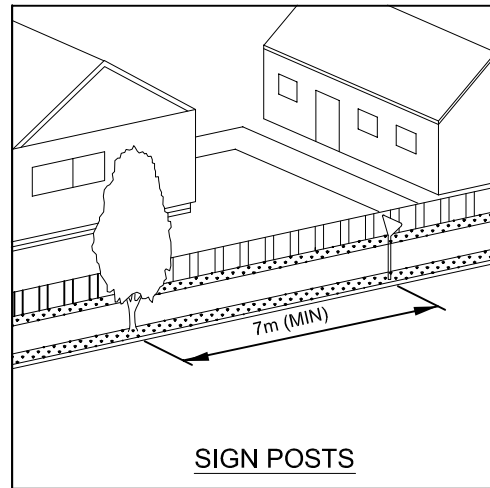
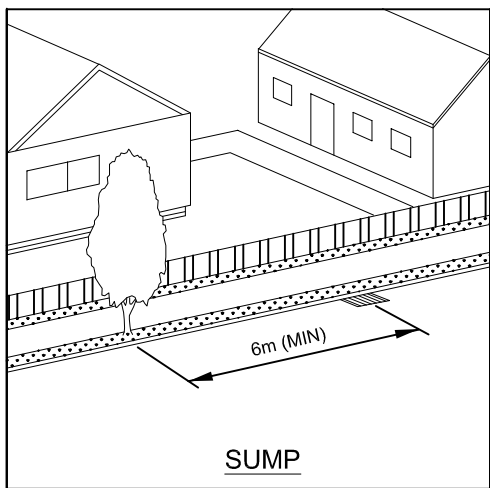
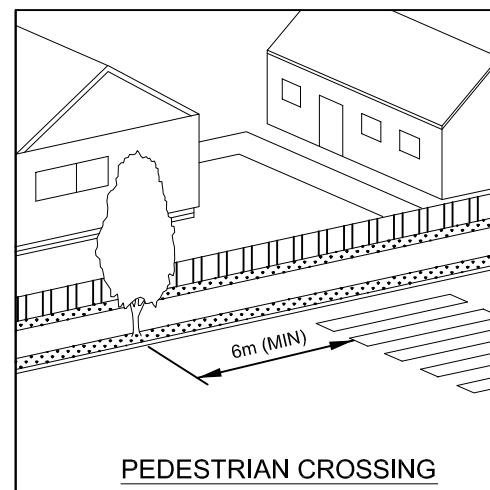
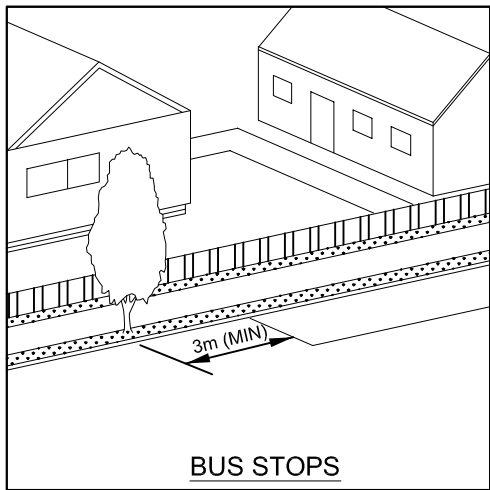
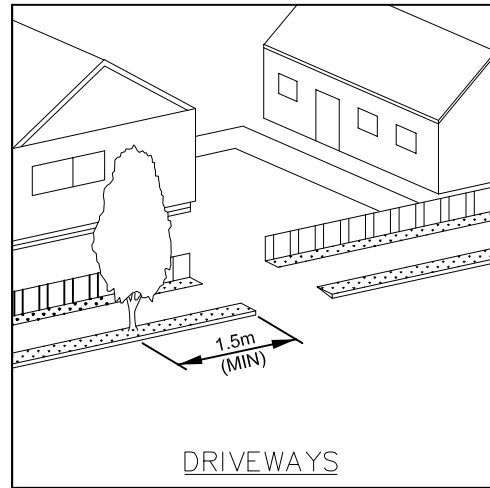
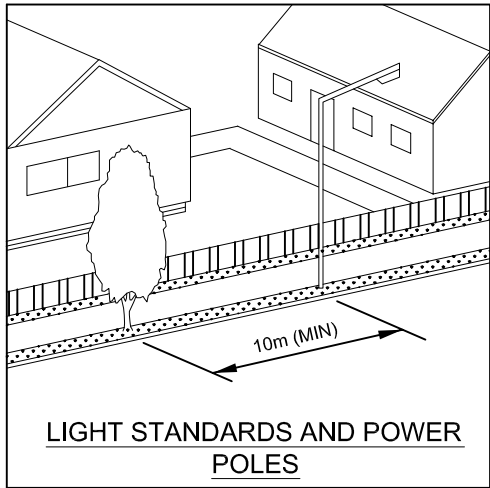

**PAPAKURA**  
DISTRICT COUNCIL

DATE ISSUED: JUNE 2009

DWG NO: P 5

# STREET TREE PLACEMENT