





Bus Routes and Stop Locations

Local bus service will continue to serve Queens Road and Pilkington Road



Key	
	RTN Route
	Local Connector Network
	Indicative Bus Stop Locations
	Bus/Rail Interchange Locations

Van Damm's Lagoon

Designation

Auckland Transport proposes to designate a portion of the Van Damm's Lagoon Recreation reserve for roading purposes. In return, existing privately owned land will be added to reserve. Auckland Transport also propose to utilise the existing pond within the reserve as part of the stormwater management plan for the project.

The initial stages of the AMETI scheme, the construction of a two-lane road from Mt Wellington Highway to Morrin Road, involves the relocation of the existing Van Damm's Lagoon car park and the creation of a new maintenance access to the reserve. The new maintenance access and relocated car park are proposed to be located on the eastern side of the reserve. The pond within the reserve will be made deeper through the removal of sediment to provide more capacity for the treatment of stormwater run-off generated by the project as well as providing a benefit for wider the catchment. The wetland habitat will be retained and enhanced with new native wetland planting.

Timeframe

Subject to confirmation of the Designation the initial scheme works are likely to occur between 2012-2014.

The construction of the future four lane AMETI proposal is likely to occur post 2020 as land development within the surrounding area intensifies.

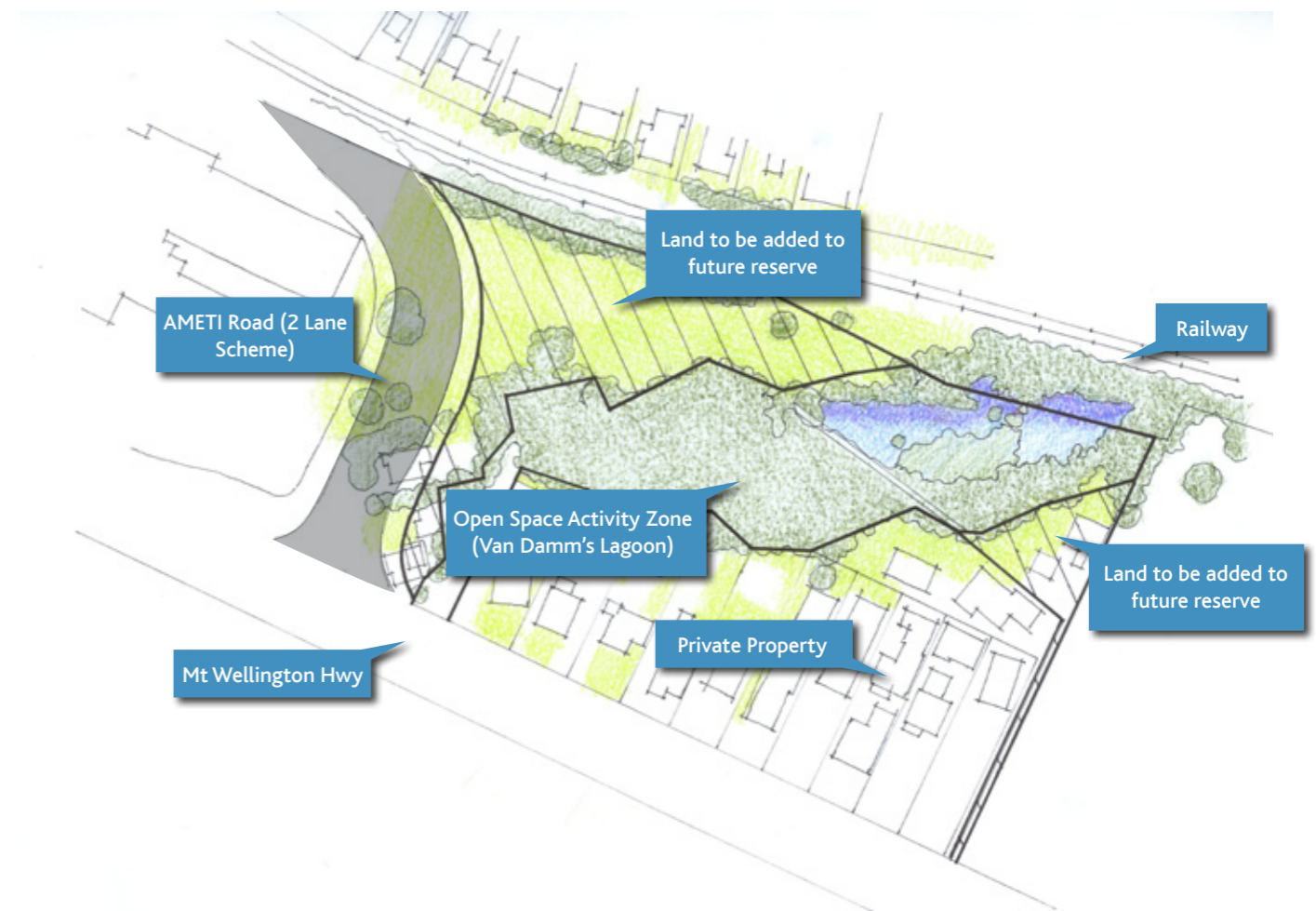

Van Damm's Lagoon Boundaries

Van Damm's Lagoon - Initial Scheme (Two Lane)



Van Damm's Lagoon - Future AMETI Scheme (Four Lane)

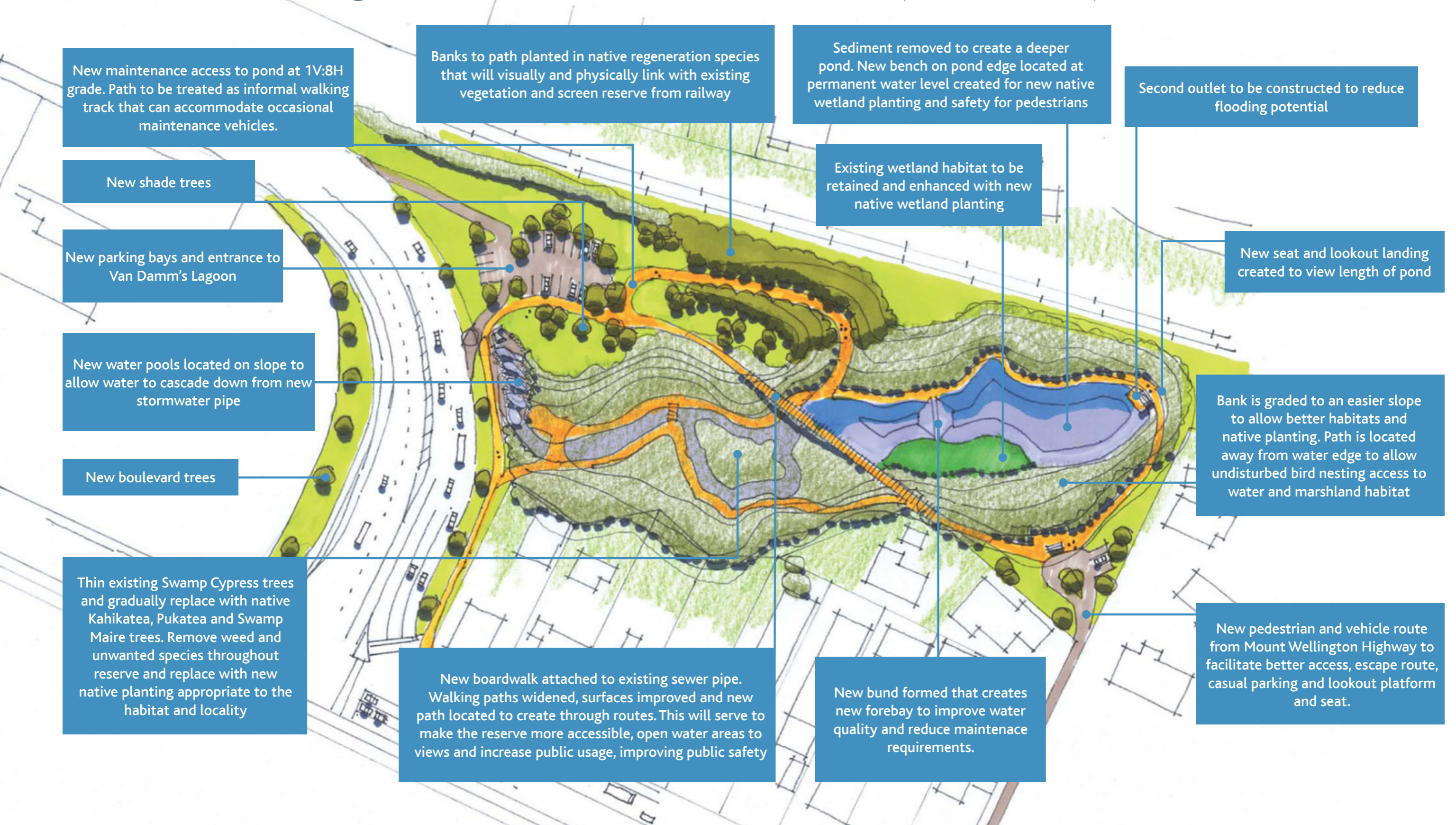

Van Damm's Lagoon

What are the impacts to Van Damm's Lagoon?

Initial Scheme

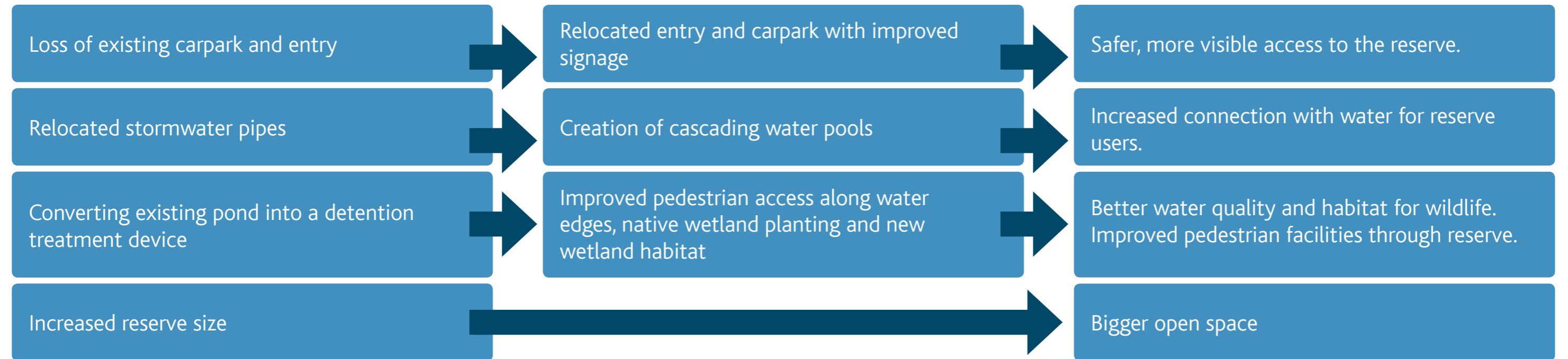

Future Four Lane Scheme

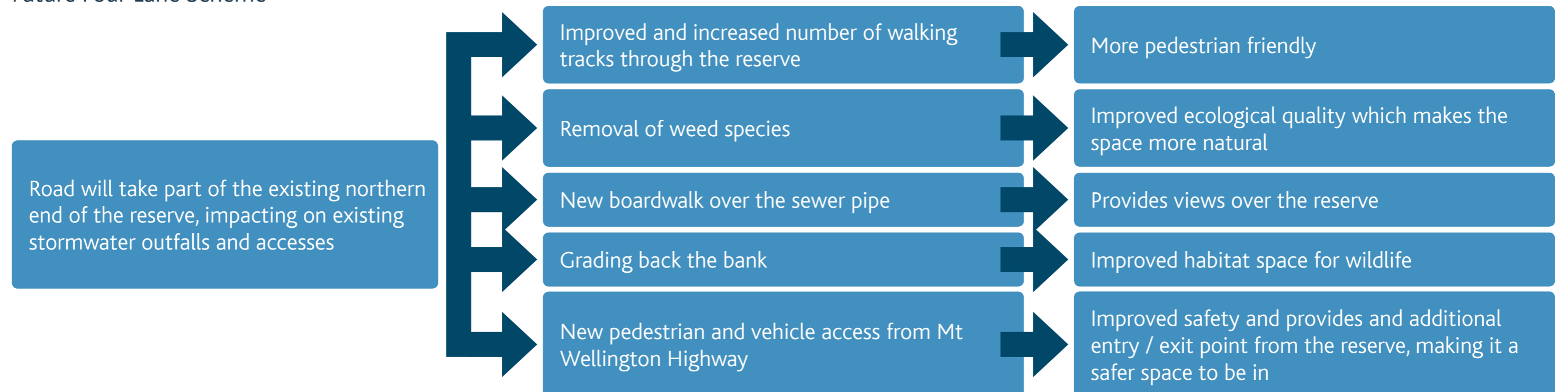

Panmure Interchange and AMETI Road Construction Sequence



1. October / November 2011



2. December 2011 / January 2012



3. End June 2012



4. End December 2012

Panmure Interchange and AMETI Road Construction Sequence



5. End January 2013



6. August 2013



7. October 2013
8. March 2014

What's Next

Phase 1

- Final Design, with completion due in July 2011
- Notices of requirements for Phase 1a and 1 will be submitted
- Construction will start in late 2011

Phase 2: Panmure Intersection and Lagoon Drive Busway

- Preliminary design will commence with completion due in November 2011
- Final design and consenting will follow
- Construction will follow completion of Phase 1 in 2014

We will continue to update the community and get feedback on plans as progress is made