

1/75

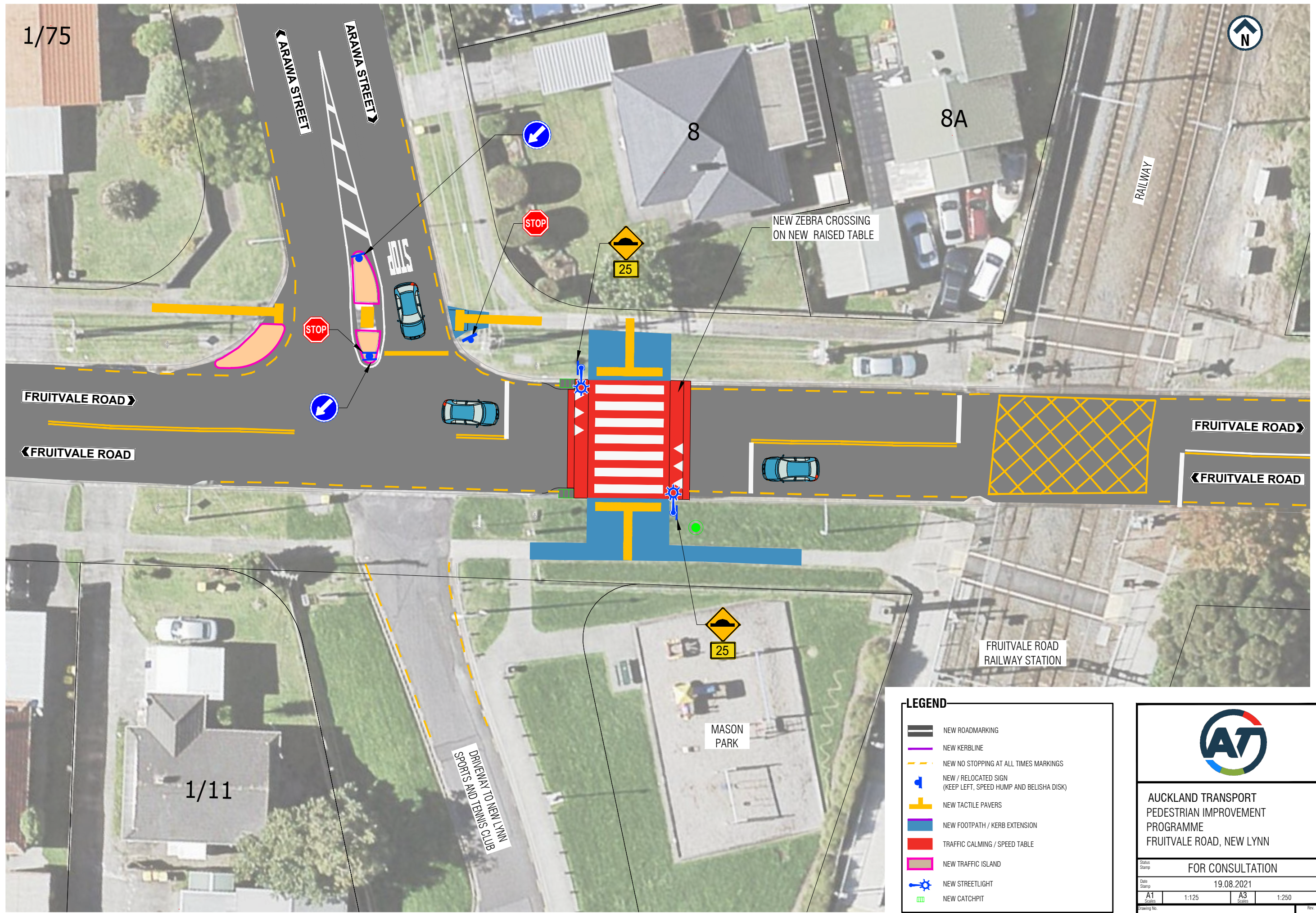

200mm DO NOT SCALE - IF IN DOUBT, ASK
150
100
90
80
70
60
50
40
30
20
10
0
ORIGINAL SIZE A1



NEW ZEBRA CROSSING ON NEW RAISED TABLE

FRUITVALE ROAD RAILWAY STATION

MASON PARK

DRIVEWAY TO NEW LYNN SPORTS AND TENNIS CLUB

1/11

LEGEND

- NEW ROADMARKING
- NEW KERBLINE
- NEW NO STOPPING AT ALL TIMES MARKINGS
- NEW / RELOCATED SIGN (KEEP LEFT, SPEED HUMP AND BELISHA DISK)
- NEW TACTILE PAVERS
- NEW FOOTPATH / KERB EXTENSION
- TRAFFIC CALMING / SPEED TABLE
- NEW TRAFFIC ISLAND
- NEW STREETLIGHT
- NEW CATCHPIT



AUCKLAND TRANSPORT
PEDESTRIAN IMPROVEMENT
PROGRAMME
FRUITVALE ROAD, NEW LYNN

FOR CONSULTATION

Date Stamp 19.08.2021

A1 Scale 1:125 A3 Scale 1:250

Drawing No. A2110796-07 Rev. A